



To complete this form: ① Fill out the form fields. ② Save the file to your computer (to make it easy to find save it to your desktop folder). ③ Email the file back to your TriStar contact. For best results, use [Adobe Reader](#). Red border = Required.

General Information

Company	Date
Contact	TriStar Contact
Address	
Phone	Email
Application	Qty.
Speed BPM	Engraving Details

Technical Specifications

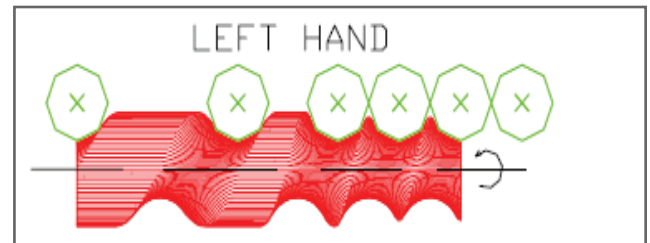
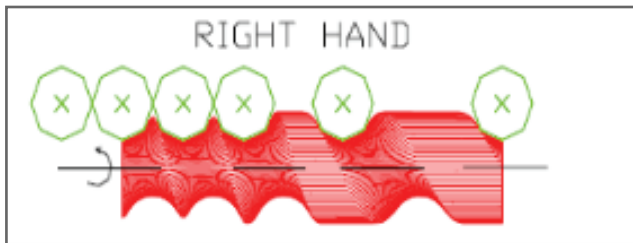

Units for this part (required): Inches Millimeters

Material	UHMWPe	Nylon
	Acetal	Other

Dimensions
L1 =
L2 =
L3 =
L4 =
L5 =
D1 =
D2 =
D3 =
D4 =
D5 =
1° =

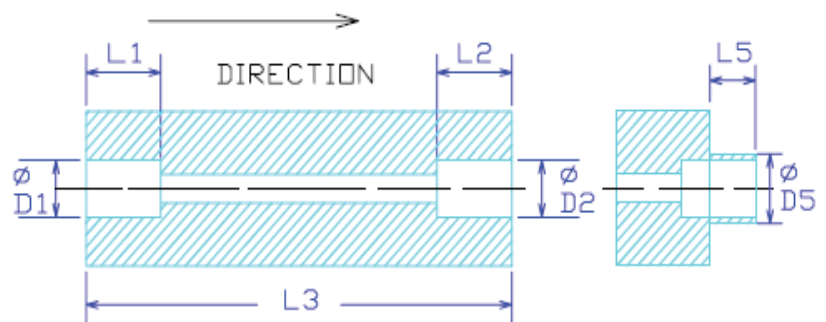
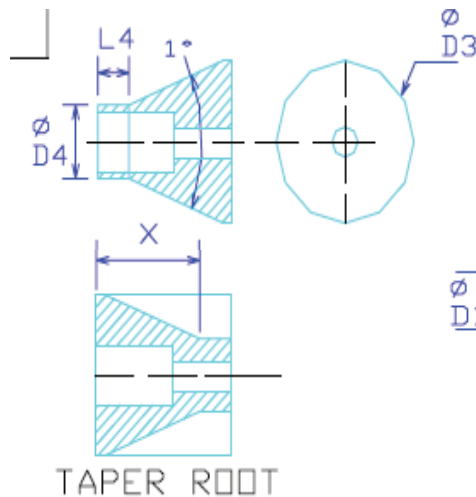

All feedscrews bored 31.75mm (1.2502 inches) and fitted with SSTL tube through

Container

Type Round Shaped

Labelled

Orientation 90° CW/CCW

Bottle Orientations

Twin

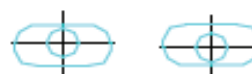

Single

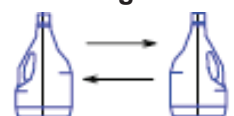

Feedscrew Detail

Dimensions	P1 =	P2 =	P3 =	P4 =	P5 =	P6 =	P7 =	P8 =
------------	------	------	------	------	------	------	------	------

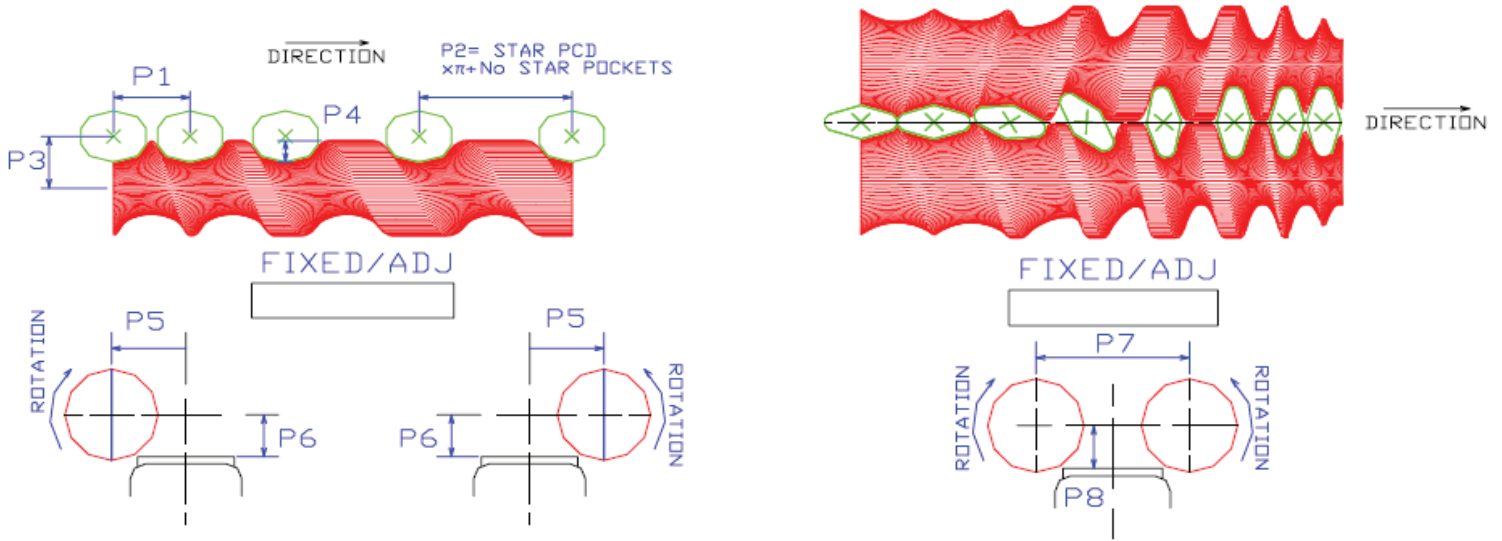

Additional Information

Conveyor: Chain Material Width

Supply Drive/Idler Details

Comments

Notes